

"THE MELODEON"

CONTACT LIST

LOCATION SITES:

THE FRED HEINRICH FARM  
Contact: IDA HEINRICH

Route 2 Box 224  
Rush City, Minnesota 55069 (612) 358-4383

HOCKMEYER BRICK FARMHOUSE  
Contact: LORING NELSON

County Road 5  
Rush City, Minnesota (612) 358-4209

Contact's son - LENHARD NELSON (612) 358-4180

Tenant: LARRY MELL (612) 358-3253

ROYALTON CEMETARY AND CHURCH

Contact: MR. & MRS. AVID CARLSON (612) 396-2342

Off Highway 70 and County 2  
Royalton (Pine County), Minnesota

NORTHERN STATES POWER

Contact: RICHARD JOHNDEL

Minneapolis, Minnesota (612) 330-6281

(Owners of land surrounding  
the Heinrich farm. Possibly  
will be used for parking and  
shooting.)

DREXEL APARTMENTS (ALLEY).

Contact: WALLACE ORFIELD (612) 332-7511

1009 Park Avenue  
Minneapolis, Minnesota  
(Between East 14th Street and  
East 10th Street)

RONALD W. ACQUISTAPACE  
12100 MITCHELL AVENUE  
LOS ANGELES, CALIF. 90049  
313/881-7408

MOTOR VEHICLES:

MIDWAY MOTORS (612) 646-2561  
Contacts: TOM KREBSBACH, SR. (612) 698-1456 (Home) or  
and (218) 543-4463 (Wkends)  
BOB HAGEN  
St. Paul, Minnesota

JOHN DEERE  
Contact: JIM COUGAN (309) 752-4655

SCHNEIDER CHEVROLET BUICK CO.  
Contact: DICK SCHNEIDER (612) 358-4721  
Rush City, Minnesota

ART ANDERSON or ROGER BYRNE  
(for antique tractors) (507) 378-4911

MIDWAY FORD SALES  
Contact: PIERRE LIPPERT (612) 636-8200  
2777 North Snelling Avenue  
St. Paul, Minnesota 55113

GOVERNMENT  
CONTACTS:

PINE COUNTY SHERIFF  
Contact: SHERIFF KOZISEK (612) 629-3930

\*\*EMERGENCY NUMBERS FOR  
POLICE  
FIRE  
AMBULANCE (612) 629-3930

CHISAGO COUNTY HIGHWAY DEPARTMENT (612) 257-4097  
Contact: LEON JOHNSON (612) 462-4766 (Home)

CHISAGO COUNTY BOARD  
Contact: DONALD HESTBECK (612) 358-4553  
(Chairman)

RUSHEBA TOWNSHIP BOARD  
Contacts: LORING NELSON (612) 358-4209  
ARTHUR COLLIANDER (612) 358-3213  
WENDELL JOHNSON (612) 358-4119

CHISAGO COUNTY SHERIFF

Contact: FLOYD N. PINOTTI

(612) 257-1300  
674-4433  
257-4100

(RUSH CITY)

\*\*Emergency numbers for

POLICE

FIRE

AMBULANCE

GAME WARDEN

(612) 674-4000

CHISAGO COUNTY GUIDE AND  
TOURISM SERVICE

Contact: ART ANDERSON

(President)

(612) 257-1579

COUNTY TREASURER

Contact: TED NURELIUS

(Wife: VIOLET)

(612) 257-4436

Highway 8

Post Office Box 505

Lindstrom, Minnesota

ST. PAUL CHAMBER OF COMMERCE

Contact: JOHN P. GEISLER

Director, Convention  
& Visitor Bureau

Suite 300, Osborn Building

St. Paul, Minnesota 55105

(612) 222-5361

TRAVEL:

HOFFMAN TRAVEL

Contact: GLORIA

TOLL FREE 1-(800) 421-4128 or  
421-4138

WESTERN AIRLINES

Twin Cities Airport

Reservations: (612) 726-4141

Air Freight: (612) 726-4343

PRODUCTION:

CBS (Affiliate: WCCO) (612) 338-0552  
Contacts: DON NEFF (Production)  
TOM DOAR (President)  
JAMES RUPP (Executive VP)

50 South 9th Street  
Minneapolis, Minnesota

NORTHWEST TELEPRODUCTIONS

Contact: CHERI McNALLY (Producer) (612) 835-4455

PRINTER:

HINCKLEY NEWS  
Contacts: PAT or JOHN (612) 384-6154

HARDWARE  
STORES:

\*Indicates  
account  
established

\*INTERSTATE LUMBER CO.  
Contact: RICK DREVECKY (612) 358-4760  
Pine City, Minnesota

\*ROBINSON HARDWARE  
Contact: HANK (612) 358-4764  
Rush City, Minnesota

JB'S HARDWARE HANK  
Contacts: PAT & JOHN BECVAR (612) 629-2225  
425 East 2nd Avenue  
Pine City, Minnesota 55063

SIGNS:

STA-BRITE SIGNS, INC.  
Contacts: JIM BERGLUND  
DENNIS THORNE  
Pine City, Minnesota (612) 629-3402

REFRIGERATION:

NORTH STAR ICE HOUSE (612) 455-0410  
Contact: JOHN F. ROONEY (612) 454-1955 (Home)  
1654 Marthaler Lane  
West St. Paul, Minnesota 55118  
(ROCKY ROONEY - Son) (612) 776-2094

COSTUMES:

UNIVERSITY OF MINNESOTA  
Contacts: DR. GERTRUDE ESTEROS  
Head of Design Dept. (612) 373-1015  
  
SHUMAN SHENOI  
Curator of Costume (612) 376-1488 or  
Collection 376-3091

GRAVESTONES:

BRAHM MONUMENT CO. (612) 396-2938  
Contact: PHILIP T. LARSON (612) 396-2324 (Home)  
Braham, Minnesota 55006

JAMES RONNING (Gravestone artist) (612) 396-2900

OFFICE SUPPLIES:

ST. PAUL BOOK & STATIONERY  
Contact: CARL BERNDT (612) 636-2250

MARCO BUSINESS PRODUCTS CO.  
Contacts: DOUG WENZ  
GREG HOWE (612) 251-4191  
609 East St. Germain  
St. Cloud, Minnesota 56301

BANK:

FARMERS & MERCHANTS STATE BANK  
Contact: (612) 384-6191  
Main Street  
Hinckley, Minnesota

HISTORICAL  
SOCIETIES:

MINNEAPOLIS HISTORICAL SOCIETY (612) 296-2747  
Contact: DOROTHY GIMMESTAD (612) 377-6514 (Home)

NORTHERN CHAPTER OF COUNTY  
HISTORICAL SOCIETY  
Contact: RAYMOND KLENK (President) (612) 358-3480

COUNTY HISTORICAL SOCIETY  
Contact: HOWARD NELSON (612) 257-1510  
Lindstrom, Minnesota

TAYLOR FALLS HISTORICAL SOCIETY  
Contact: JOHN GROSSMAN (President) (612) 465-7303

LOCAL PRODUCTION  
HELP:

DICK JACOBSON

(612) 358-4779 (Office)  
(612) 629-3385 (Home)

WALLACE ANDERSON

(612) 257-1233

STEVEN REYLEK

(612) 257-4457

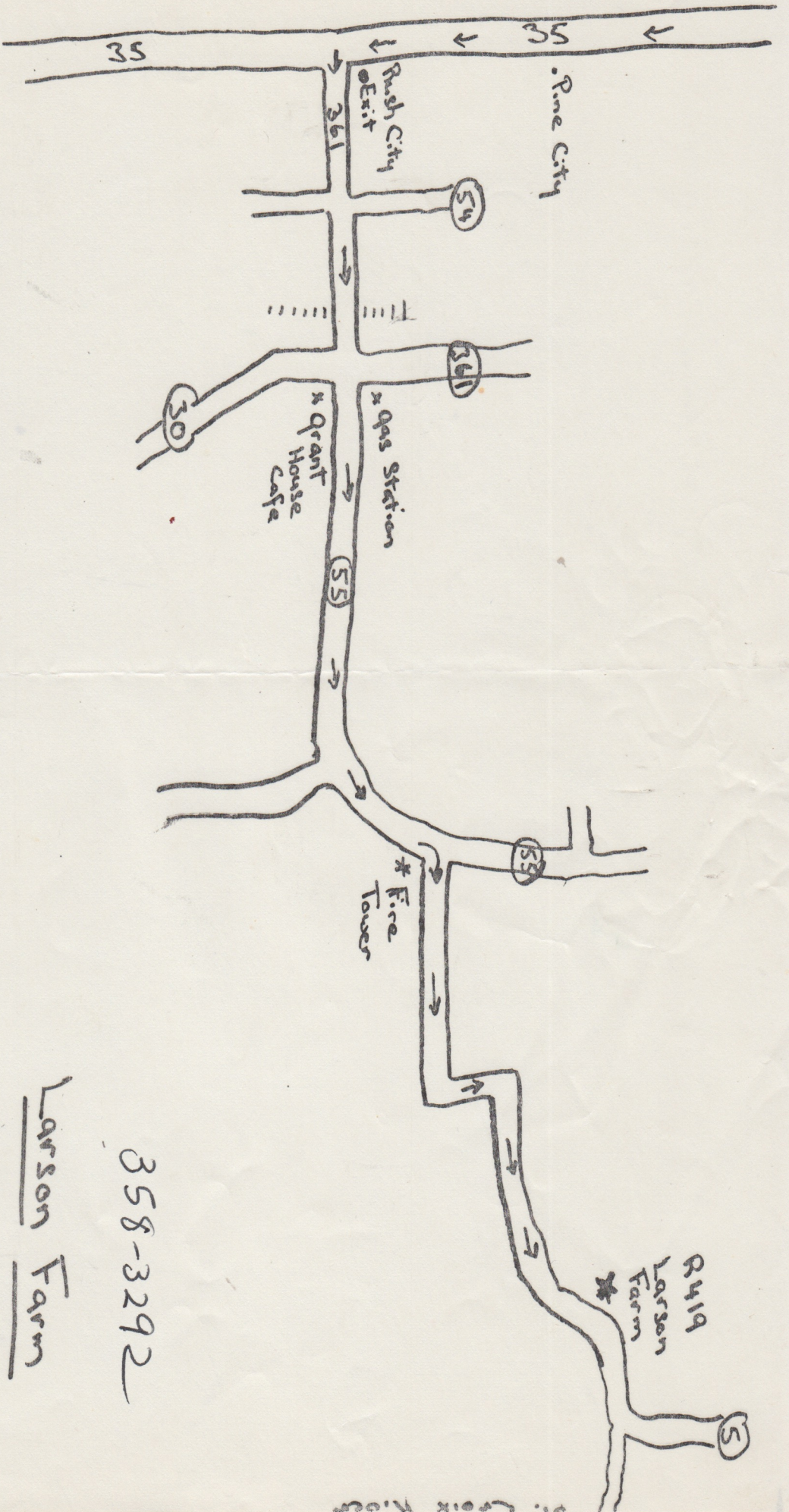

Directions to LARSON FARM from HINCKLEY:

35 South to RUSH CITY Exit -- follow sign for RUSH CITY LEFT off Exit Ramp -- go into downtown Rush City over railroad tracks to intersection where Grant House Cafe is on the far right -- go straight past Grant House and follow this road (55) while it bears LEFT and black top ends -- look for grey FIRE TOWER on the right and turn hard RIGHT on DIRT ROAD that runs past it. 3.4 miles from exit ramp. Follow this road as it winds all the way to our location, marked FIRE ROAD 419. Approximately 6 miles from Exit ramp.

Larson Farm

358-3292

3 + E  
S

# Tent + Tractor + Field

35 SOUTH to GRANTSBURG Exit. RIGHT on HIGHWAY 70 going WEST (LEFT if you're coming from Twin Cities) go past JUNCTION 1. Take FIRST LEFT off 70 WEST after JUNCTION 1 (six miles from Exit off 35). Go to the end of this DIRT ROAD and turn left (COUNTY 102). Field and Tent will be one-eighth of a mile on LEFT.

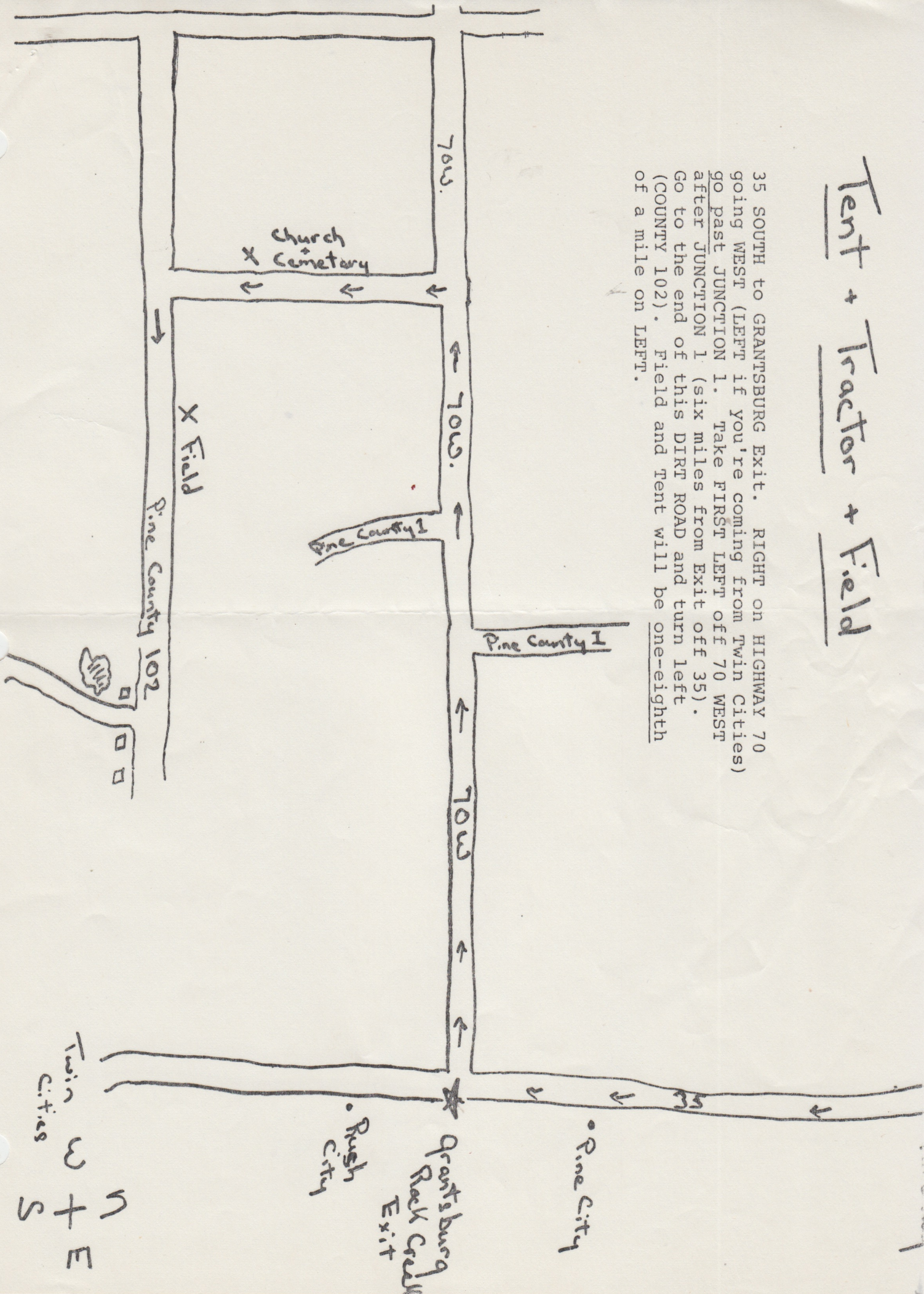

# Church + Cemetary

Directions to CHURCH from HINCKLEY:

35 South to Grantsburg Exit -- Right on Hwy 70 going WEST, (LEFT if you're coming from Twin Cities), go past Jct. 1 -- take first LEFT off 70 West after Jct 1 (6 miles from Exit off 35) -- This is a dirt road. Go up Approx. 1/2 mile to White Church on the RIGHT.

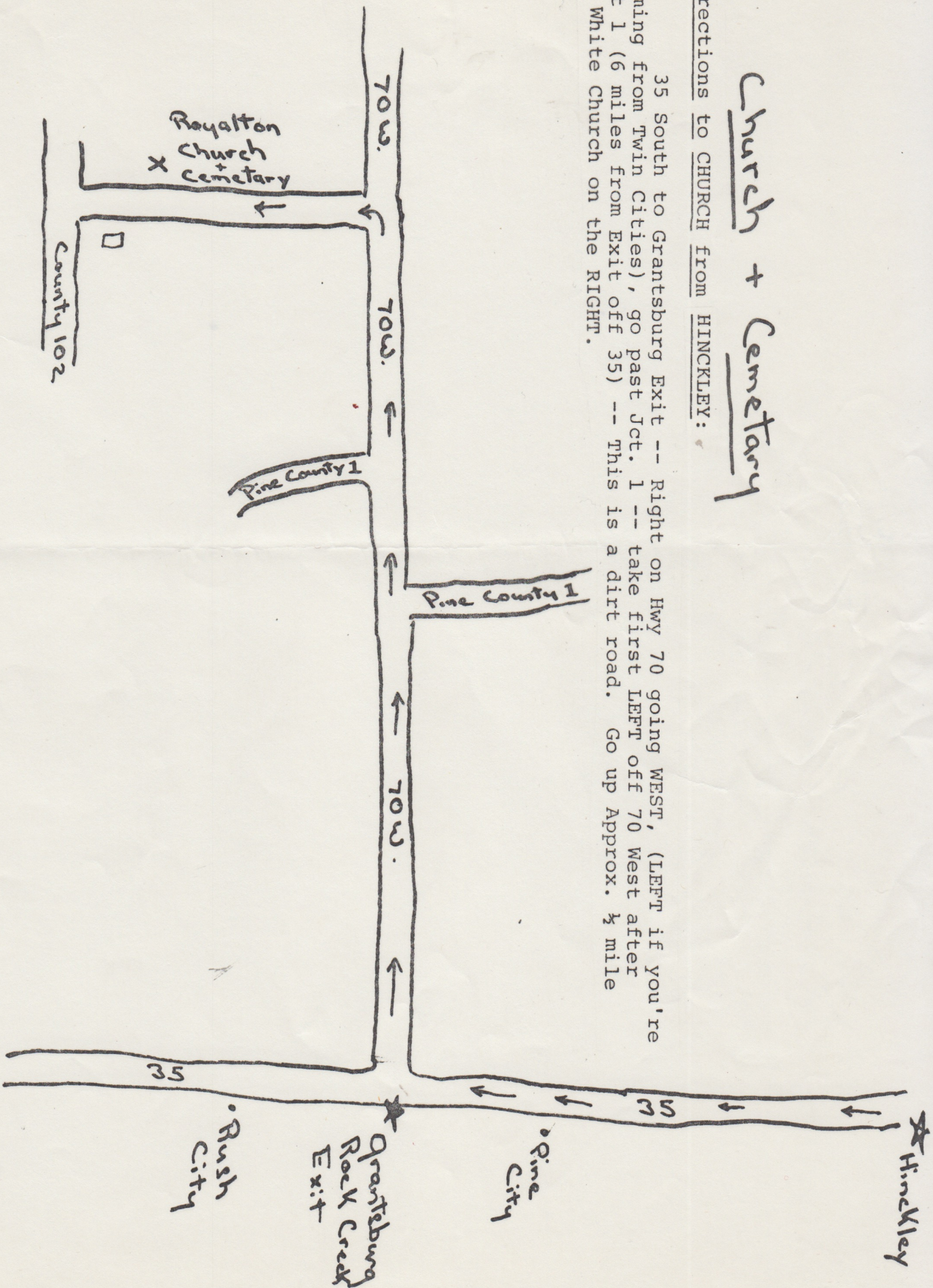

\* Hinckley

# Hockmeyer Farm

DIRECTIONS TO HOCKMEYER FARM FROM HINCKLEY

35 SOUTH to RUSH CITY EXIT -- Follow sign for RUSH CITY. LEFT off Exit Ramp. Go into downtown Rush City OVER RAILROAD TRACKS to INTERSECTION where GRANT HOUSE CAFE is on the FAR RIGHT. RIGHT TURN here puts you on COUNTY 30. Take LEFT at COUNTY 5. Go about ONE MILE to FIRST RIGHT TURN. House is FIRST place on the LEFT.

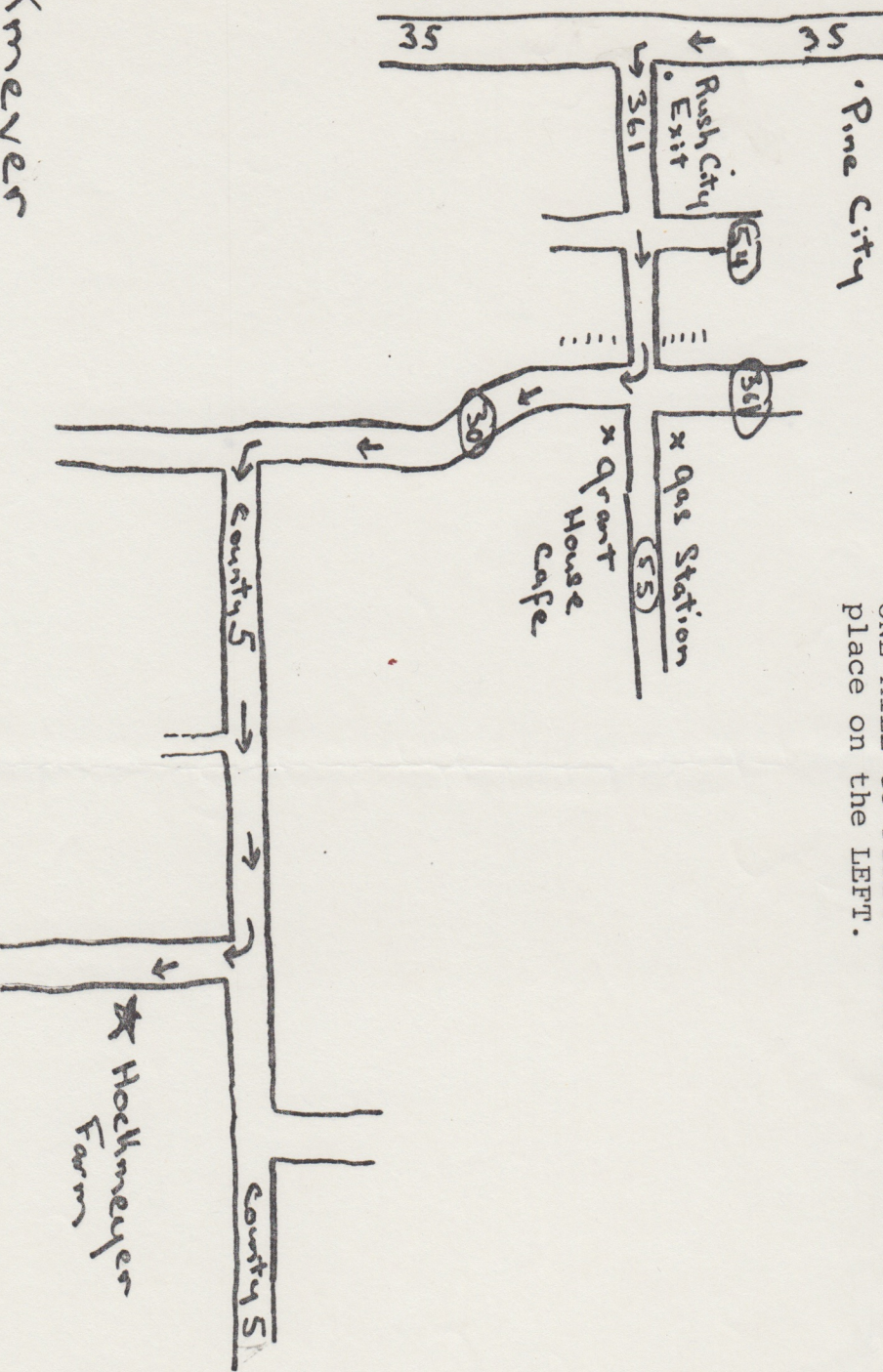

Hockmeyer

Farm

N  
+  
E

# Run-by Area and Tree-lined Road

Directions to RUN-BY AREA and TREE-LINED ROAD from HINCKLEY:

Take 35 South to Grantsberg Exit -- RIGHT on Hwy 70 going WEST. (Left if you're coming from Twin Cities), go past Jct 1 -- take first LEFT off 70 West after Jct 1 (6 miles from Exit off 35) --from there -- --

For RUN-BY AREA:

go to end of this dirt road and turn RIGHT (County 102) -- at T go LEFT -- Hill with TRACTOR ROAD at its base is on your RIGHT.

For TREE-LINED ROAD:

go to end of dirt road and turn LEFT on County 102. There is a long dirt road between 2 houses on your right, slightly past a small LAKE. This is access to the TREE-LINED ROAD.

